

RTS-M Remote Test Switch and Status Monitor

Si-125, Si-250, Si-375 and Si-550 (including - PST models)

INVERTER REMOTE STATUS AND TEST PANEL WIRING INSTRUCTIONS

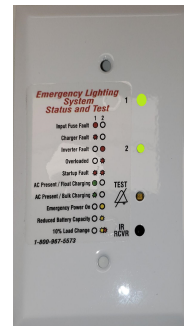
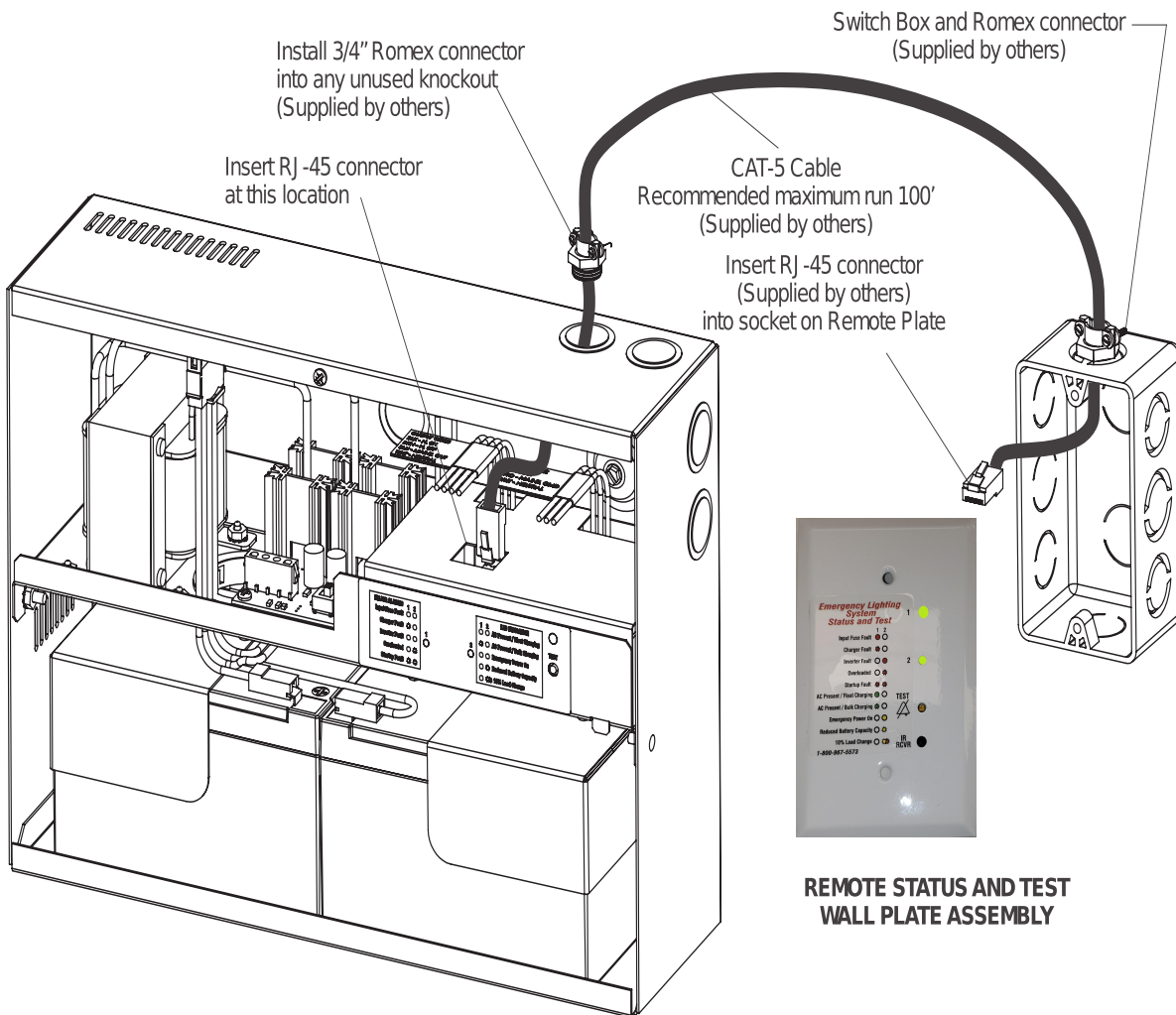

**REMOTE STATUS AND TEST
WALL PLATE ASSEMBLY**

"NOT INTENDED FOR NETWORK CONNECTION"

Note: RJ-45/CAT-5 cable is used for direct connection from Inverter to Remote Display only.

RTS-M Features:

- System status display, test buttons, self-diagnostic LED Indicators, buzzer and system status LED's
- Easy to read monitor plate details and status
- Remote display installs easily in a standard switch box
- Quick interconnect from inverter to remote test panel with Cat. 5 cable (not provided)
- RJ 45 connection points provided on inverter and remote test display PC boards
- Remote Test Display can be mounted up to 100' from the inverter,
- Suitable for wall or ceiling mounting